

PANEL CUT-OUT

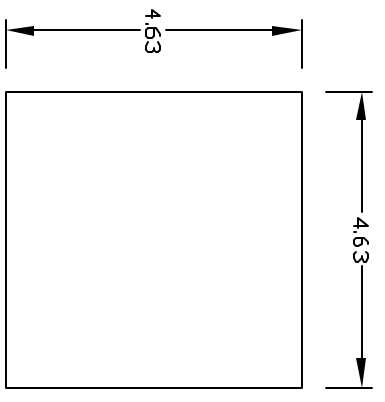

PANEL MOUNT DETAIL

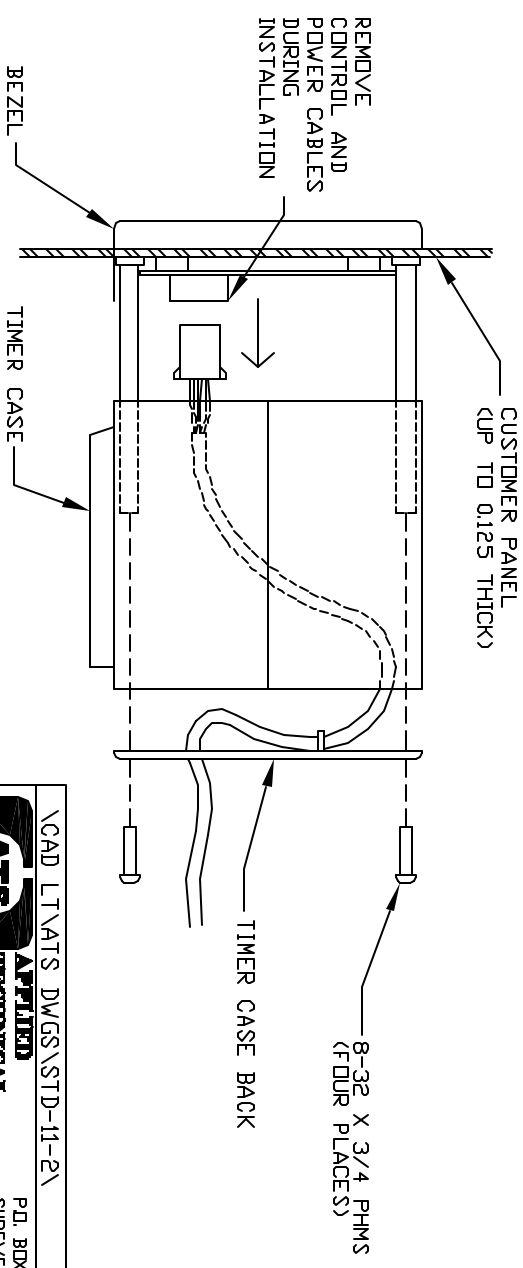

ENCLOSURE CAN BE FREE STANDING OR PANEL MOUNTED
 PANEL MOUNTING REQUIRES 4.63 X 4.63 CUTOUT
 REMOVE 4 8-32 X 3/4 PHM SCREWS FROM BACK PANEL
 DISCONNECT CONTROL AND POWER CONNECTORS
 REMOVE TIMER CASE AND INSTALL FRONT PANEL THROUGH CUTOUT
 REASSEMBLE TIMER CASE AND BACK PANEL
 BE SURE TO RECONNECT CONTROL AND POWER CABLES

DRAWN BY		DTI		3/20/03	
REVISED		A		5/8/03	
PROJECT					
VCAD LTY\ATS DWGS\STD-11-2\			P.O. BOX 5705		
APPLIED TECHNICAL SYSTEMS			SHREVEPORT, LA		
STD-525T			71135		
PRECISION TIMER			SCALE 1:3		
DESCRIPTION			JOB #		
ASSEMBLY			SHEET #		
			REVISION		
			TEL. DRAWING		
			STD525TASY1		
			DRAWING #		